

06 May 2022  
Ref: 21164

Ms Shirley Leung  
Dentons

E: [shirley.leung@dentons.com](mailto:shirley.leung@dentons.com)

Dear Shirley

**Proposed Residential Development  
22 Redan Street, Mosman**

---

I have assessed the revised plans relevant to Council's Statement of Facts and Contentions.

The following advice is provided in relation to the Contention 9.

- (a) The turning paths for the Unit 4 & 5 parking spaces are satisfactory as shown on the attached diagrams
- (b) The dimensions are now shown on the parking spaces
- (c) A car wash bay is now provided in accordance with the DCP criteria
- (d) A motorcycle space is now shown in accordance with the DCP criteria
- (e) The sight distance in relation to Fig 3.2 of AS2890.1 is compliant due to the speed hump constrained speed in Redan Street at the site frontage.

The site distance in relation to Fig 3.3 is indicated on the plans.

- (f) The "alternative solution" to the grading specified in AS2890.1 is demonstrated in my letter of 17<sup>th</sup> March and it is understood that the Council officer responsible for traffic assessment is satisfied with this arrangement.

Yours faithfully

A handwritten signature in black ink, appearing to be 'RN' or similar, written in a cursive style.

Ross Nettle  
Director  
Transport and Traffic Planning Associates

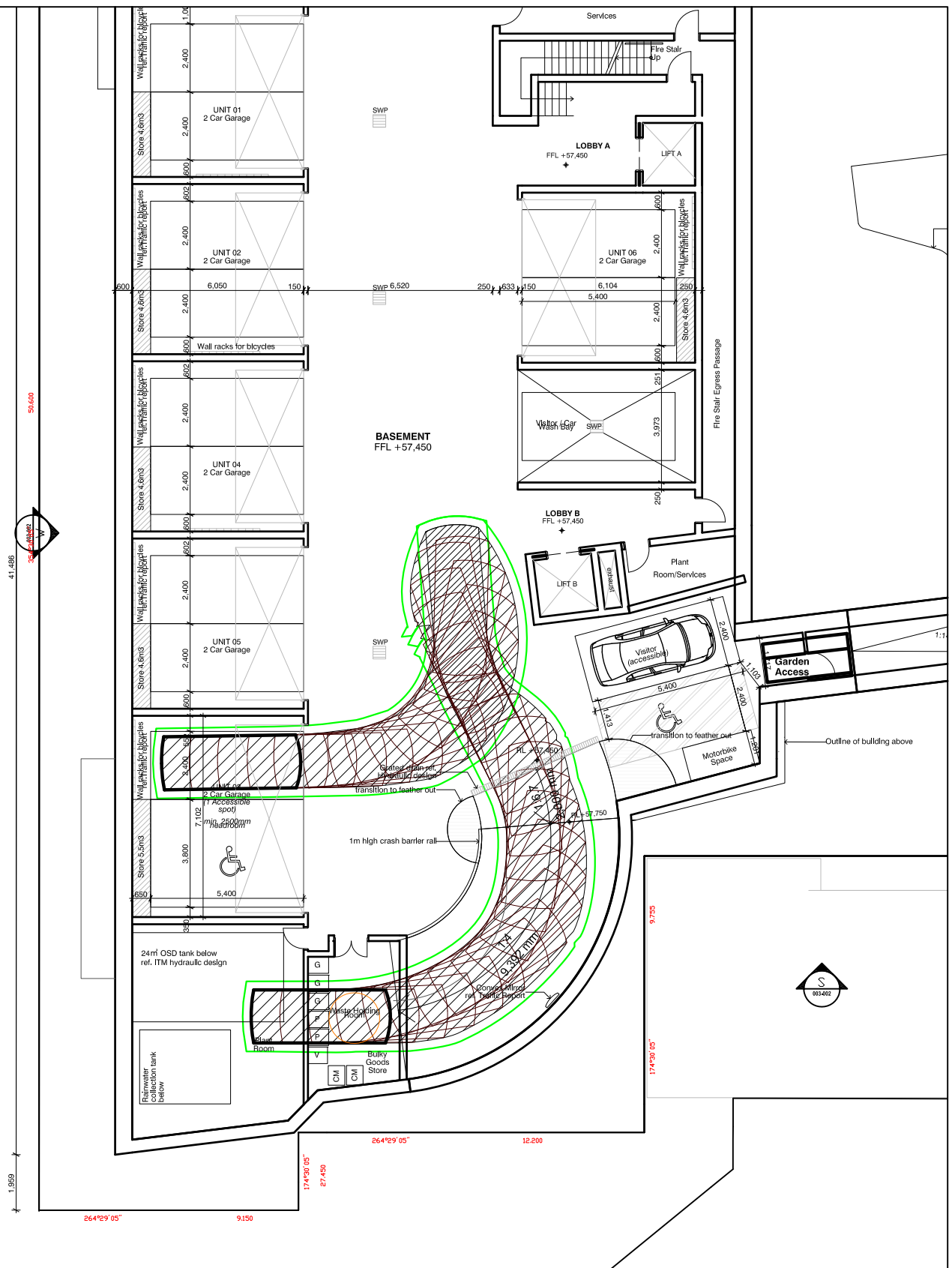

## NOTE

This drawing has been prepared using vehicle modelling computer software AutoTrack V5.00a in conjunction with AutoCAD 2013. The vehicle used is based upon vehicle data provided by Austroads and incorporates a reasonable degree of tolerance. However, it is not possible to account for all vehicle types/characteristics and/or driver ability.

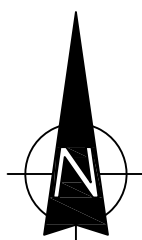

**SWEPT PATH ANALYSIS  
OF AN 85th PERCENTILE  
VEHICLE ENTERING THE SITE**

**SP 9**

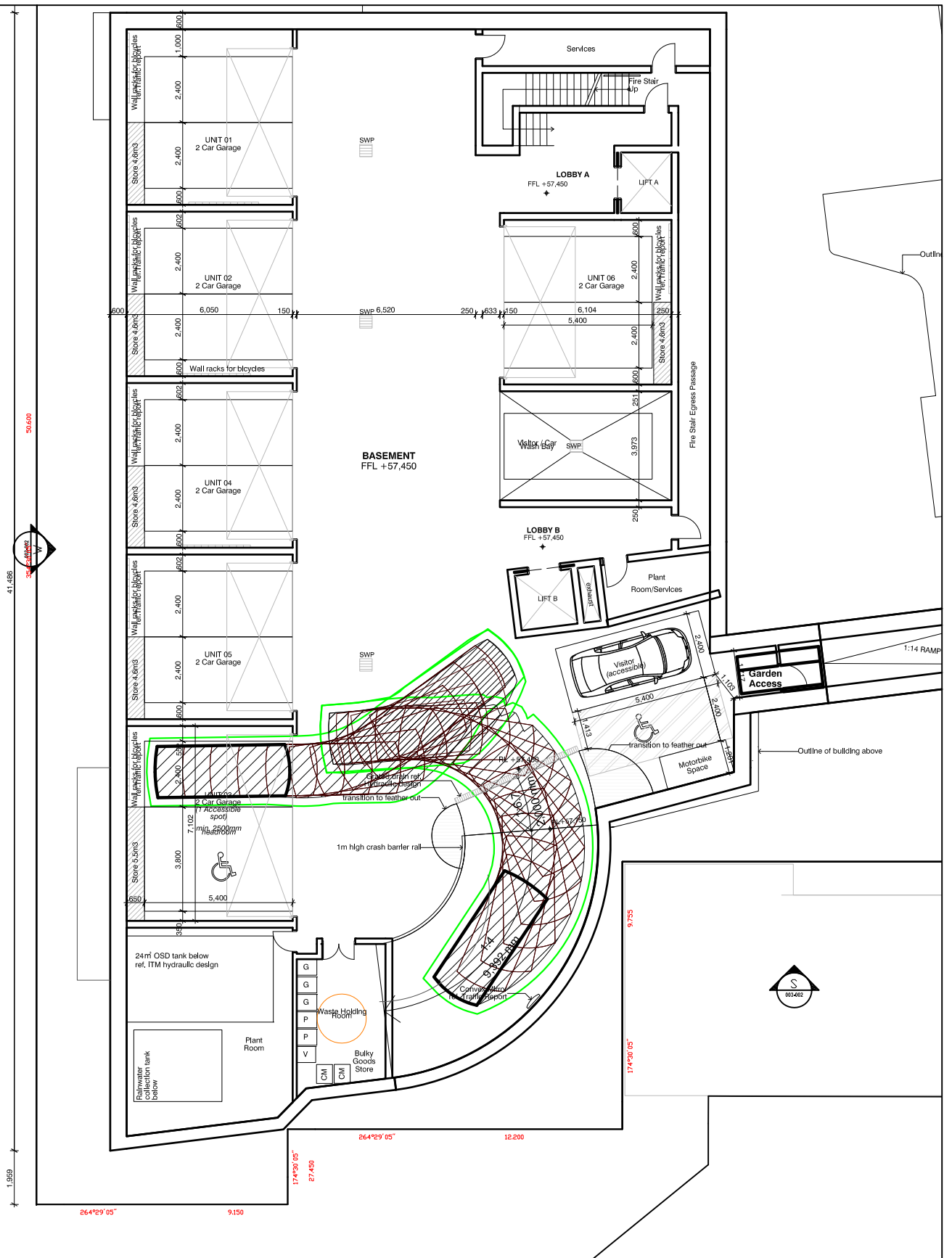

## NOTE

This drawing has been prepared using vehicle modelling computer software AutoTrack V5.00a in conjunction with AutoCAD 2013. The vehicle used is based upon vehicle data provided by Austroads and incorporates a reasonable degree of tolerance. However, it is not possible to account for all vehicle types/characteristics and/or driver ability.

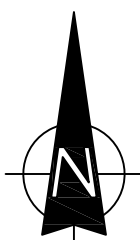

**SWEPT PATH ANALYSIS  
OF AN 85th PERCENTILE  
VEHICLE EXITING THE SITE**

**SP 10**

